

Panel construction – plug-in system



Decor area consists of panel A + B, Total decor area approx. 1 m².



As accessory and tools you only need: acrylic glue, hand or table saw, yardstick and pencil, screw gun/drill, screws, perhaps dowels.

First you measure the area to be coated and calculate the number of panels needed.



Start with the installation on the lower left corner.

You will have to remove the left side row of teeth including the tab of the panel. Mark the cutting line on the back of the panel and look for a straight and accurate marking.



Saw, e.g. with a circular saw with a guide rail, slowly along the marking. If necessary, cut notches with a jigsaw.

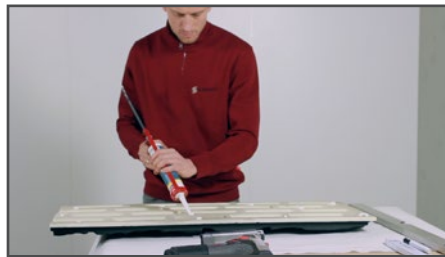

Apply selectively acrylic glue on the back of the panel.



Level the panel horizontally and press it flat against the wall.

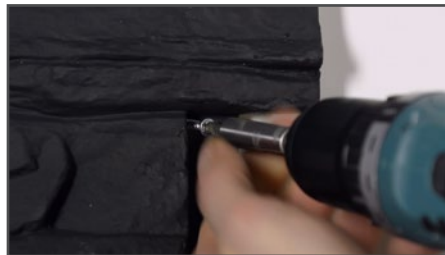

In our example we can screw directly into the timber wall without dowels.

For massiv stone and concrete walls, drill concurrently a hole in the panel bracket and the wall. Insert a screw into the dowel and tighten them slightly. Then drive it into the wall and tighten the screw until both are tight.

For gypsum walls, use appropriate dowels.



After fixing the first panel, proceed the same way with the following panels. Thereby the panel to be attached has to be pushed very tight to the front side of the already fixed panel.

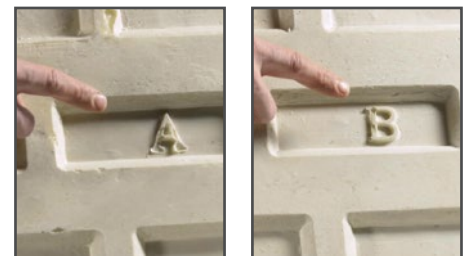

Please consider that the pattern repeat is followed.

Joints should be running parallel.



With the cut piece from the last panel of the ready row, you should start the next row on the upper left side. Please note that the offcut should have at least a width of 20 cm. Then install the next rows until you reach the desired height.

Please check our processing video on our homepage before you start:

www.imi-beton.com/video-channel

art.-no./discription	colour	panel dimension in mm		m ² per panel (decor area)	weight per panel
		high	width		
2000 crushed stone	grey	440	1.050	0,42	approx. 2 kg
2300 crushed stone	ocher	440	1.050	0,42	approx. 2 kg
2400 crushed stone	black	440	1.050	0,42	approx. 2 kg
3100 wide rippled	weiß	415	1.230	0,47	approx. 2 kg
3200 wide rippled	anthracite	415	1.230	0,47	approx. 2 kg
3300 wide rippled	ocher	415	1.230	0,47	approx. 2 kg
3500 wide rippled	silver-grey	415	1.230	0,47	approx. 2 kg
4100 straight rippled	white	400	1.210	0,44	approx. 2 kg
4200 straight rippled	anthracite	400	1.210	0,44	approx. 2 kg
4300 straight rippled	ocher	400	1.210	0,44	approx. 2 kg
4500 straight rippled	silver-grey	400	1.210	0,44	approx. 2 kg
7100 V1 Brick	white	610	1.094	0,60	approx. 2 kg
7100 V2 Clinker	white	460	1.155	0,48	approx. 2 kg
7600 V1 Brick	red	610	1.094	0,60	approx. 2 kg
7600 V2 Clinker	red	460	1.155	0,48	approx. 2 kg

A decorative element consists of 2 panels (Part A and Part B). Because of the precisely fitting plug-in system, additional components like filler, colour and patina are no more necessary for processing. Exclusively for the repairs and edge finishing these accessories are needed. The panels can be screwed invisible at the lateral fold (advantage: removal possible) and/ or attached point by point with contact glue.